

Notes

Check all dimensions on site. Do not scale from this drawing
Report any discrepancies and omissions to HLM Architects
This Drawing is Copyright ©

DESIGN/SKETCH DESIGN
Unless stated otherwise, the designs shown are subject to detailed site survey, investigations, and legal definition, the CDM Regulations, and the comments and / or approval of the various relevant Local Authority Officers, Statutory Undertakers, Fire Officers, Engineers and the like. They are copyright, project specific and confidential and no part is to be used or copied in any way without the express prior consent of HLM Architects.

PHOTOCOPIED/SCANNED INFORMATION
NB This drawing is based on photocopied / scanned information liable to distortion in scale.

AREA CALCULATIONS
NB The areas shown are approximate only and have been measured off preliminary drawings as the likely areas at the current state of design using the stated option from the Code of Measuring Practice, 4th edition. RICS/ISVA. These may be affected by future design development and construction tolerances, or the result of surveys for existing buildings. Take account of these factors before planning any financial or property development purpose or strategy and seek confirmation of latest areas before decision making.

3RD-PARTY INFORMATION
NB This drawing includes information provided by independent surveyors and/or consultants, to whom all queries shall be made. HLM Architects can accept no liability for its content or accuracy.

Key Plan

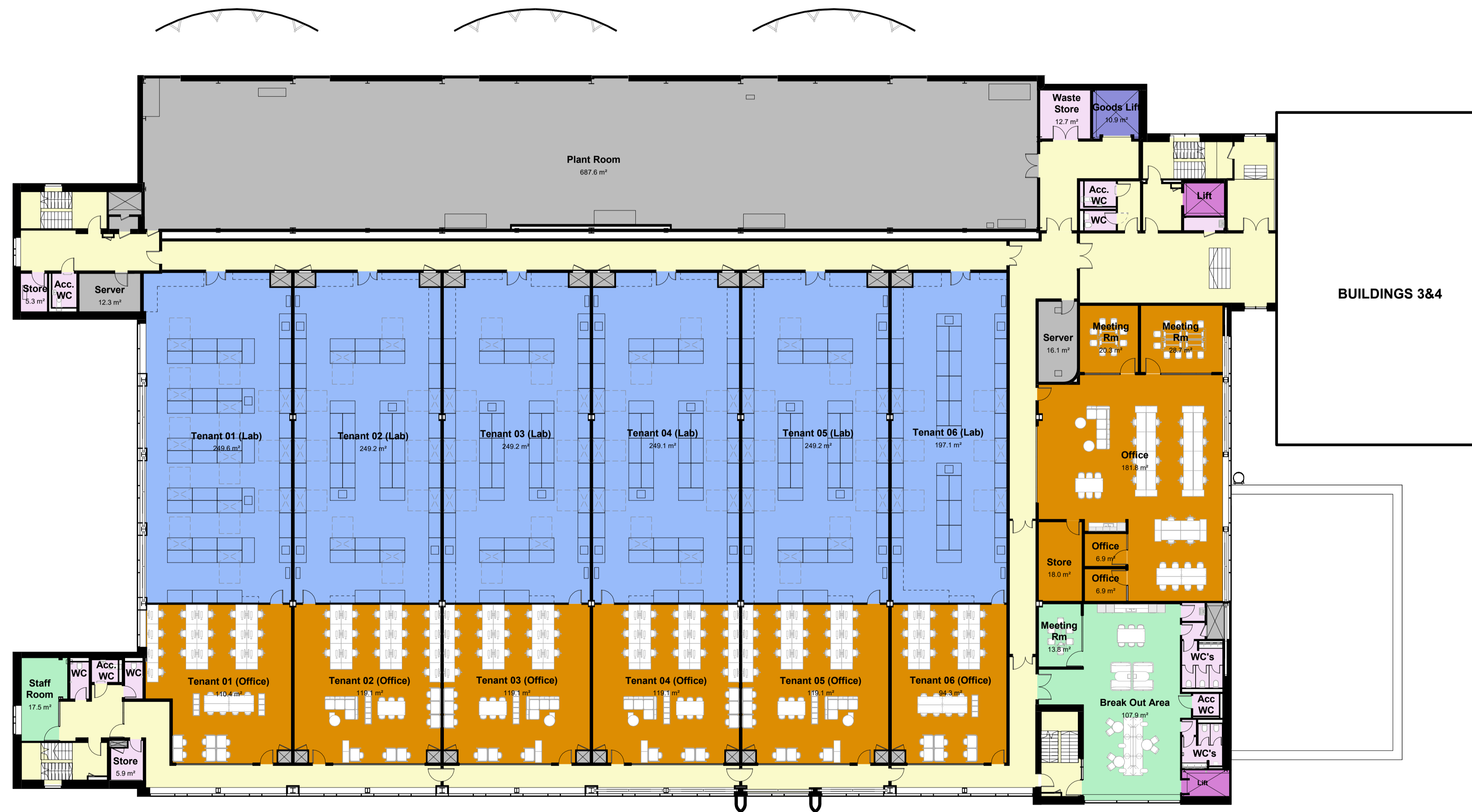
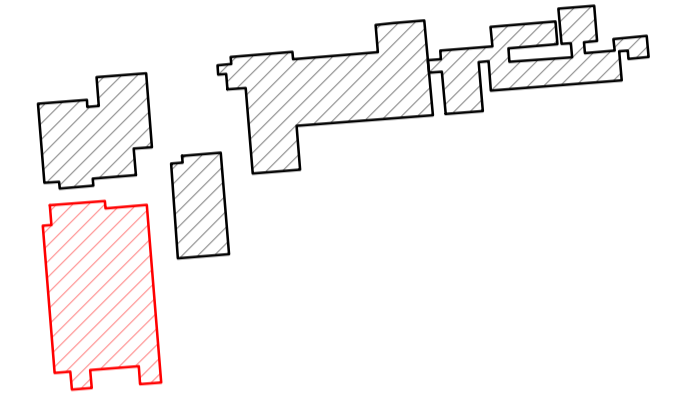

P07	Issued for Information	11/04/24	SL	HLM
P06	Issued for Information	10/04/24	SL	HLM
P05	Issued for Stage 3	31/01/24	SL	HLM
P04	DRAFT Stage 3	22/01/24	SL	HLM
P03	For Information	05/12/23	SL	HLM
P02	For Information	01/12/23	SL	HLM
P01	For Information	27/11/23	SL	HLM
Rev	Description	Date	By	Chk

Revisions	Suitability
Project	S2 INFORMATION

**13-1201-03
RIVERLABS 2a**

Client
RIVERLABS PHASE 01

Title
PROPOSED FIRST FLOOR GA PLAN (MULTI-TENANT) - OPTION 02

Drawing No.	Revision
RLW-HLM-2A-01-DR-A-00121	P07

Scale	Drawn
1 : 200 @A1	SL
Date	Checked
23/11/23	HLM



© HLMArchitects
2nd Floor
Ailsa Court
121 West Regent Street
Glasgow G2 2SD

www.hlmarchitects.com
T. +44 (0) 141 226 8320
F. +44 (0) 141 226 8350
glasgow@hlmarchitects.com

